

Installation Instructions

NID-PT6KIT Network Interface Device

1.0 GENERAL PRODUCT INFORMATION

1.1 The Network Interface Device (NID) provides a demarcation point between the telephone service provider network and the subscriber's telephone wires. The NID contains up to 6 station protectors*. The protectors* provide primary electrical protection for subscribers.

1.2 Each protector* can connect one pair of 26-22 AWG central office (c.o.) wire and one pair of subscriber wires. The protector comes with weather resistant (gel or grease-filled) IDC connections for easy termination (tools not required) and a RJ-11 covered subscriber test jack. Meets or exceeds RUS, PE80, Telecordia GR1361 & UL 497.

1.3 The NID housing is constructed from UL approved PVC material and is UV stabilized. It is wall and pole mountable.

2.0 CAUTIONS AND WARNINGS

- Use company approved safety practices and equipment
- Use solid conductors only
- **DO NOT USE STRANDED WIRE**
- Do not strip insulation from conductors

3.0 KIT CONTENTS

- One housing contains up to six protectors*. (See FIGURE 2)
- One ground bar
- One ground strap

4.0 ADDITIONAL REQUIRED MATERIALS

- Tool used to open the housing's telco side
- Screwdriver
- Bond clamp

5.0 INSTALLATION INSTRUCTIONS

5.1 Mount Housing

- a) Open front cover and install screws through mounting slots in the housing base. (See FIGURE 1).
- b) Route the central office (c.o.) wire through the bottom entry port. Remove the outer sheath and install bullet bond. Ensure enough length of wire to reach the IDC protectors*.

5.2 Connecting central office (c.o.) pair to IDC protector* route cable pair through the bottom of the hinged cover and install c.o. wires into the IN position of the IDC protector (See Figure 1 & 2). Connect customer pair to the OUT going side of the IDC protector*.

6.0 Testing

To test central office (c.o.) wire pair, insert test clip into test ports.

* NOTE: Protectors are: ST356, PR356 or other equivalent product

NID-PT6KIT

Network Interface Device

Figure 1

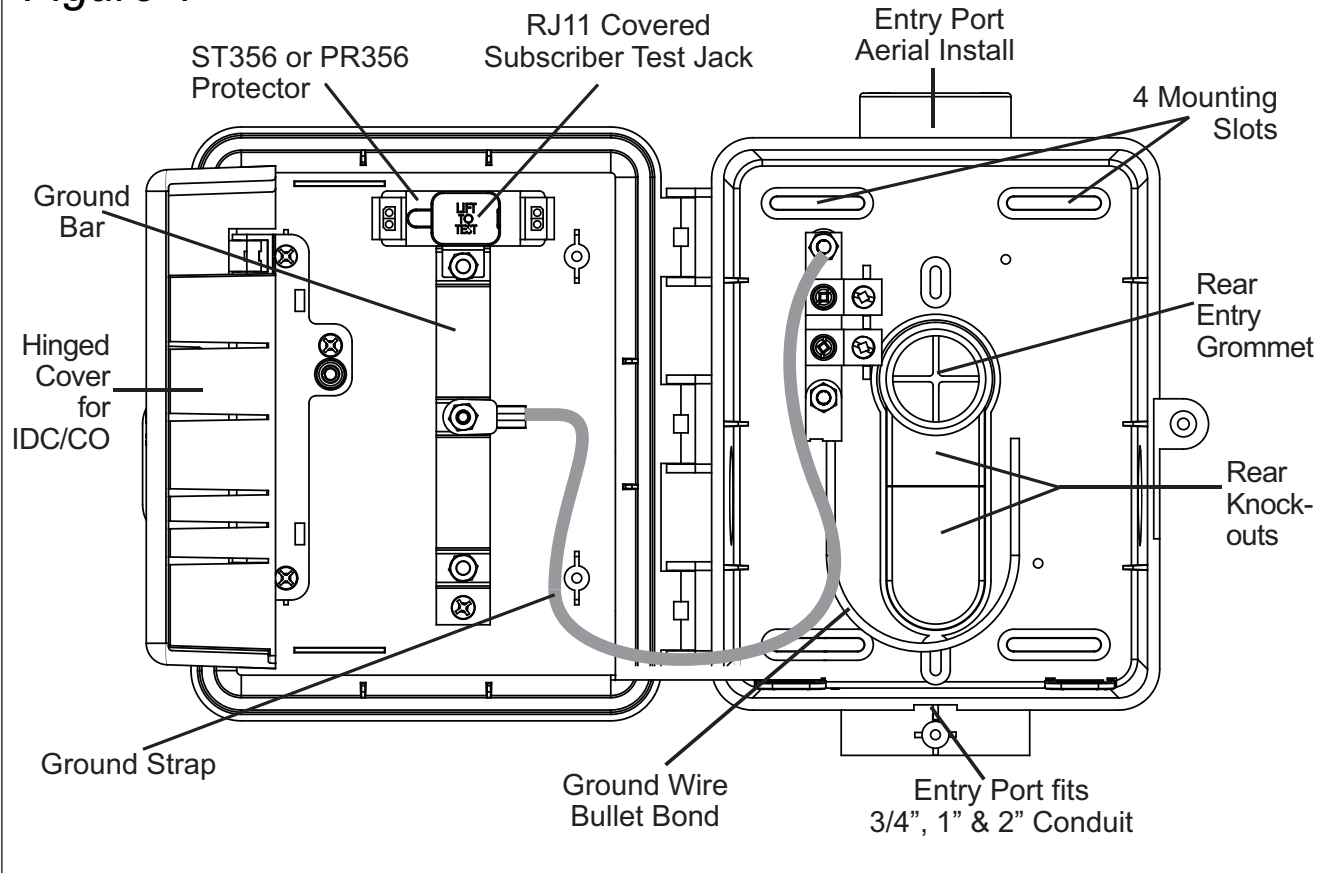
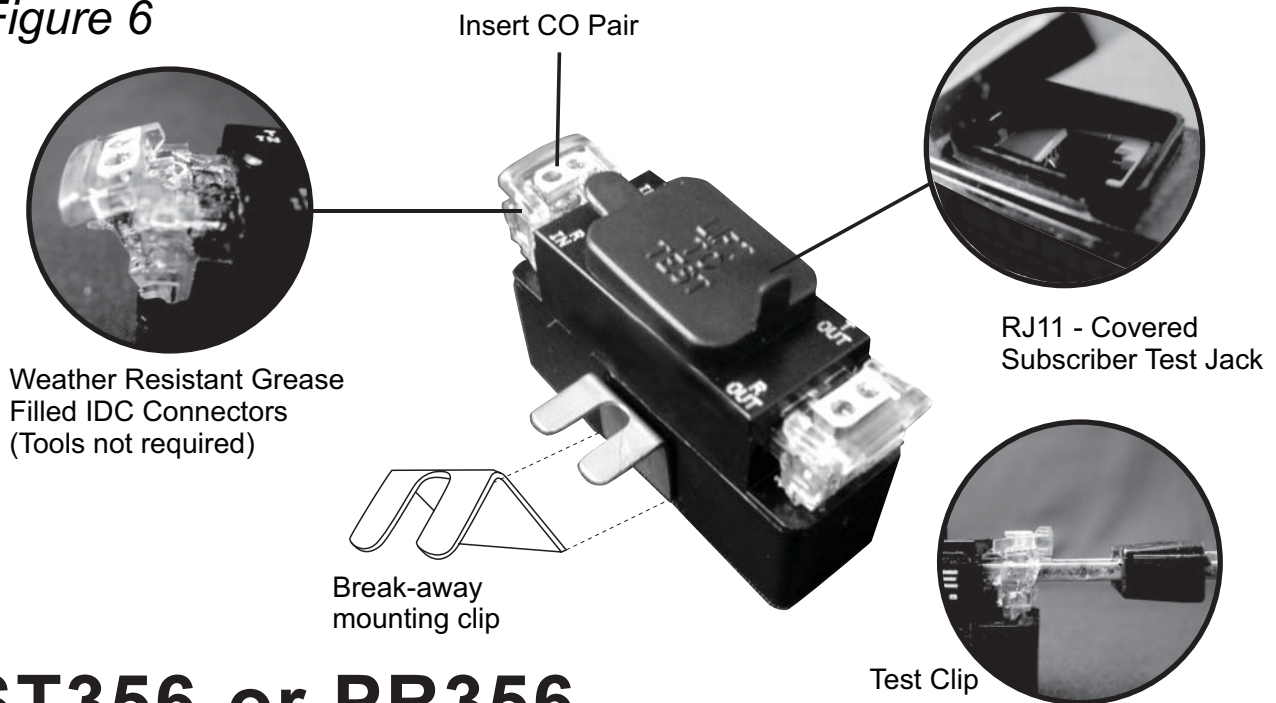

Figure 6



ST356 or PR356